

Serie

CL1-6

 Kg max  
400

 Power supply  
Batteries

CL1-6 is the vacuum lifter specific for handling and installing insulated panels. Due to its modular frame, it can be adapted to install both wall and roof panels. CL1-6 is equipped with 6 suction pads with a **maximum capacity of 400kg**. The **tilting system** makes it possible to safely move the horizontally-resting sandwich panels by tilting them vertically.

The modularity and flexibility of CL1-6 also apply to the type of panels it can lift, including **flat, micro-rib and trapezoidal**, either in **mineral wool** or in **polyurethane**. In addition to this, CL1-6 can also be customized to lift special panels, such as **roof tile shaped and other special profile panels**.

To optimize space during storage and transportation, the vacuum lifter comes with the handy **parking stand for forklift** equipped with a protective cover. The structure of the lifter can be disassembled and stored inside the stand, which measures only 100x80x145 cm, to minimize its volume during the transport.

## Technical specifications

<b>Application</b>	Installation of insulated roofing and wall panels horizontally and vertically Smooth, micro-rib and trapezoidal panels
<b>Capacity</b>	Max 400 kg
<b>Suction pads</b>	N. 6 vacuum pads (mm 800x120) Special fast-replacement gaskets
<b>Load movement</b>	Tilting system 0-90° 90° frame rotation for vertical installation
<b>Operating system</b>	DC vacuum pump powered from on-board batteries High capacity re-chargeable batteries with battery level indicator Battery charger included Quick change battery pack
<b>Vacuum system</b>	2 independent vacuum circuits, each vacuum circuit with vacuum reserve and non-return valve
<b>Weight of lifter</b>	Depends on configurations
<b>Control</b>	Manual ON/OFF valve for load suction and release Release of the load by dual action security command Radio remote control for load suction and release (optional)
<b>Standard features</b>	Audible and visual low vacuum warning devices Vacuum gauge for each vacuum circuit Battery charger 240 Volt Lockable vertical and horizontal tilting



Tilt system 0-90°



Dual vacuum circuit built to EN13155 standard



Radio remote control as optional



Modular frame



Safety systems



Parking stand



## Cladding Vacuum Lifter

### Technical drawings for roofing panels

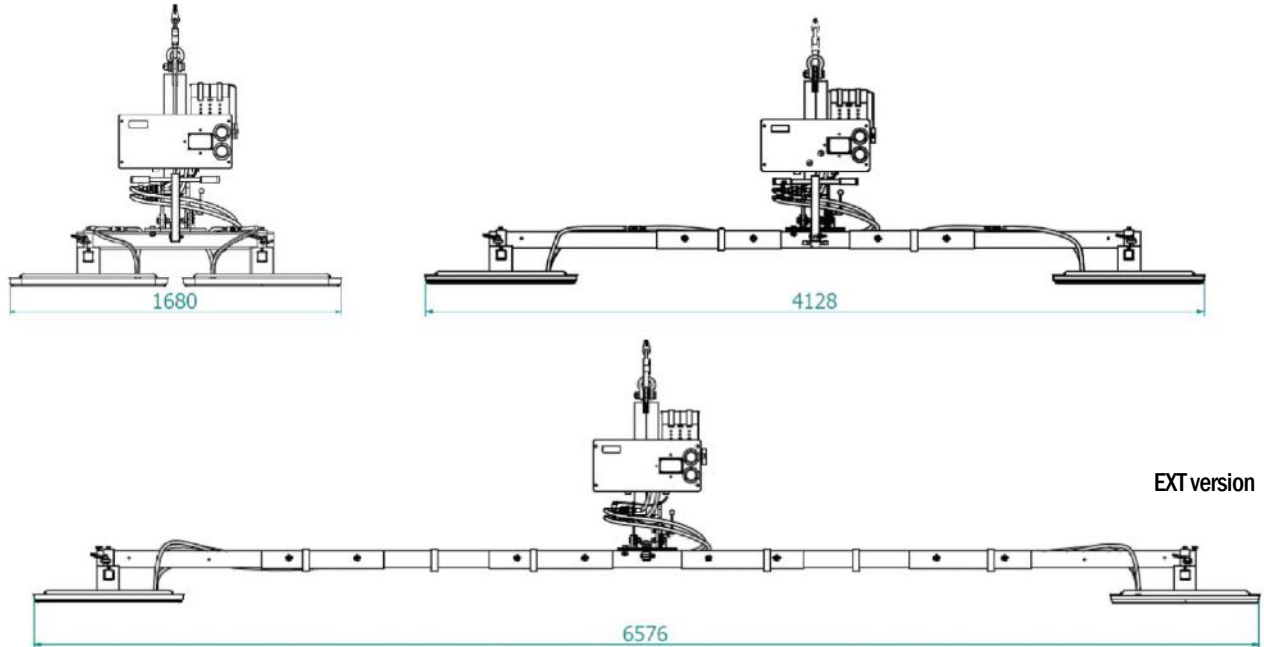

### Technical drawings for wall panels

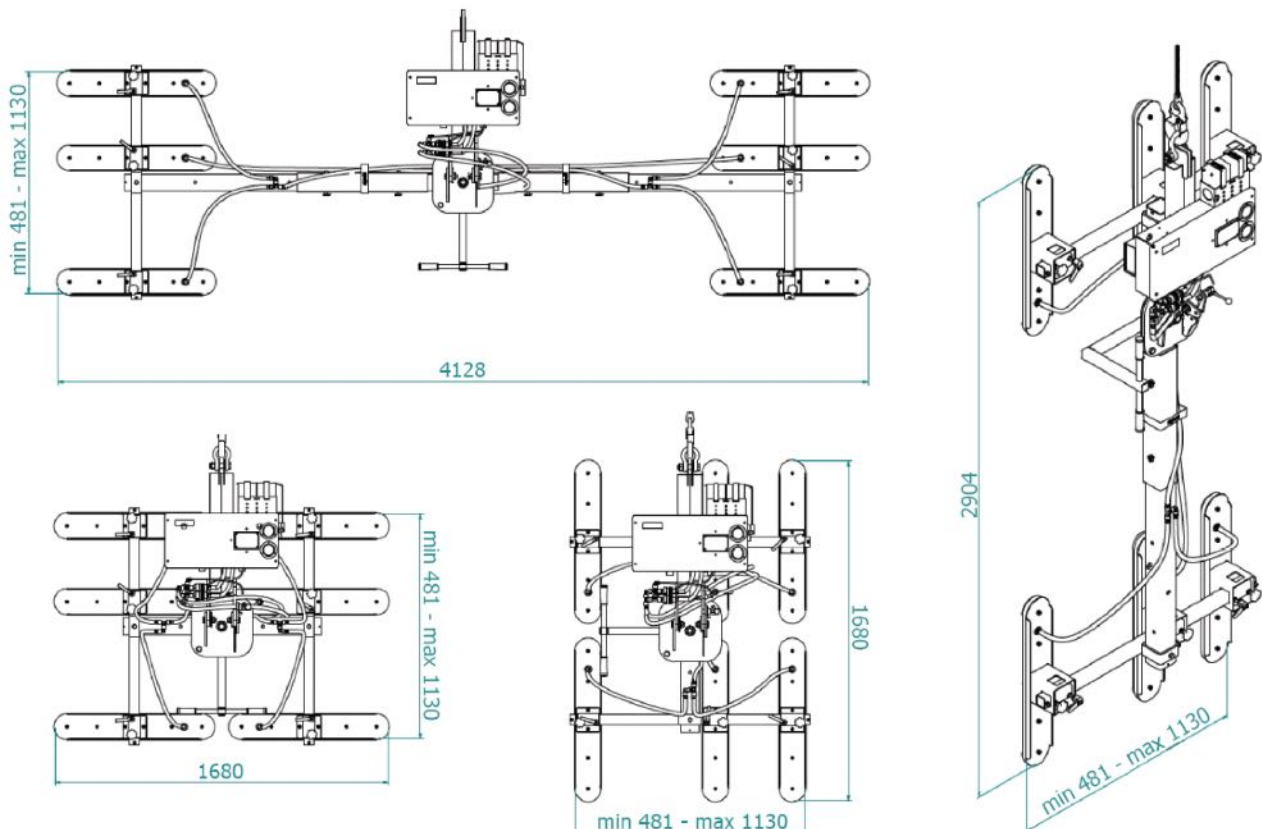

## Cladding Vacuum Lifter

### Accessories included



#### Parking stand for forklift

Forkable pallet-sized parking stand for easy storage and transport. Protective cover included.



#### Specific pads for panels

The special seal that composes the panel pads is specially designed to ensure an easy and immediate grip on different types of panels (smooth, trapezoidal, micro-ribbed).



#### Support for assembled vacuum lifter

Steel base to support the assembled vacuum lifter without damaging the pads when not in use.



#### Tilt assistant bracket

Practical metal tilt assistant attachment to vacuum lifter suspension for making tilting from horizontal to vertical position extremely easy.



#### Spare battery kit

Additional kit of high-capacity batteries to easily replace the low ones without interrupting your job, if needed.



#### External charger

External charger to always have the spare batteries kit in charge.

### Optional to choose



Remote control

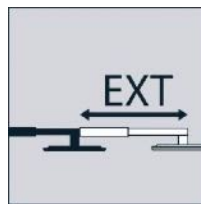

Extension arms

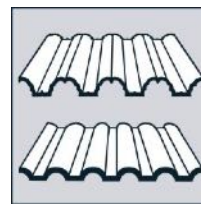

Special pads



Additional alarm

### Available models

Capacity (kg)	N. pads	Suction and release	Extension up to 4 m	Extension up to 6,5m
400	6	Manual	CL1-6	CL1-6-EXT
400	6	Radio remote control	CL1-6 RC	CL1-6EXT-RC