



**HIGHLIGHT**

**Joystick control:**

This lift can turn around its own axis using the joystick.



## SL 208 INDOOR

LIFTS UP TO 208 KG / 460 LBS.

The SL 208 Indoor is our most compact and manoeuvrable lift. Easy to control using a joystick and supported by two powerful 1,500W electric motors making the lift capable of rotating on its own axis.

This glass robot is ideal for indoor installation where space might be limited or in industrial production facilities.

### TECHNICAL SPECIFICATIONS

Lifting cap. arm in/out	208/150 kg - 460/330 lbs.
Lifting height	2,740 mm / 108 in.
Extension of arm	500 mm / 20 in.
Tip from horizontal	54° back / 53° fwd.
Side shift	-
Charging voltage	230 V / 110V
Charging time	Approx. 8 hrs.
Battery (2 x 12V)	2 x 70 Ah
Running period	Up to 10 hrs.
Rear-wheel drive	2 x 1,500 W DC
Brake	Electro-magnetic
Suction pads	4 x Ø200mm / 4 x Ø10 in.
Width	720 mm / 28 in.
Curb weight	480 kg / 1,060 lbs.



TURNING RADIUS  
**87.5 CM** /34 IN.



LIFTING HEIGHT  
**270 CM** /106 IN.



Compact in size and tight turning radius

### BUILD YOUR SMARTLIFT

Foam-filled tyres	NA
Single Gyro	■
Electric key switch	■
White, non-marking tires	■
Special Color	■
Wireless remote	■
Manual extension of the arm	NA
Electrical extension of the arm	NA
Electrical rotating yoke	NA

■ Select the options you need



**SMARTLIFT®**

## SL 208 INDOOR

### TECHNICAL SPECIFICATIONS

Lifting cap. arm in/out	208/150 kg - 460/330 lbs.
Lifting height	2,740 mm / 108 in.
Extension of arm	500 mm / 20 in.
Tip from horizontal	54° back / 53° fwd.
Side shift	-
Charging voltage	230 V / 110V
Charging time	Approx. 8 hrs.
Battery (2 x 12V)	2 x 70 Ah
Running period	Up to 10 hrs.
Rear-wheel drive	2 x 1,500 W DC
Brake	Electro-magnetic
Suction pads	4 x Ø200mm / 4 x Ø10 in.
Width	720 mm / 28 in.
Curb weight	480 kg / 1,060 lbs.

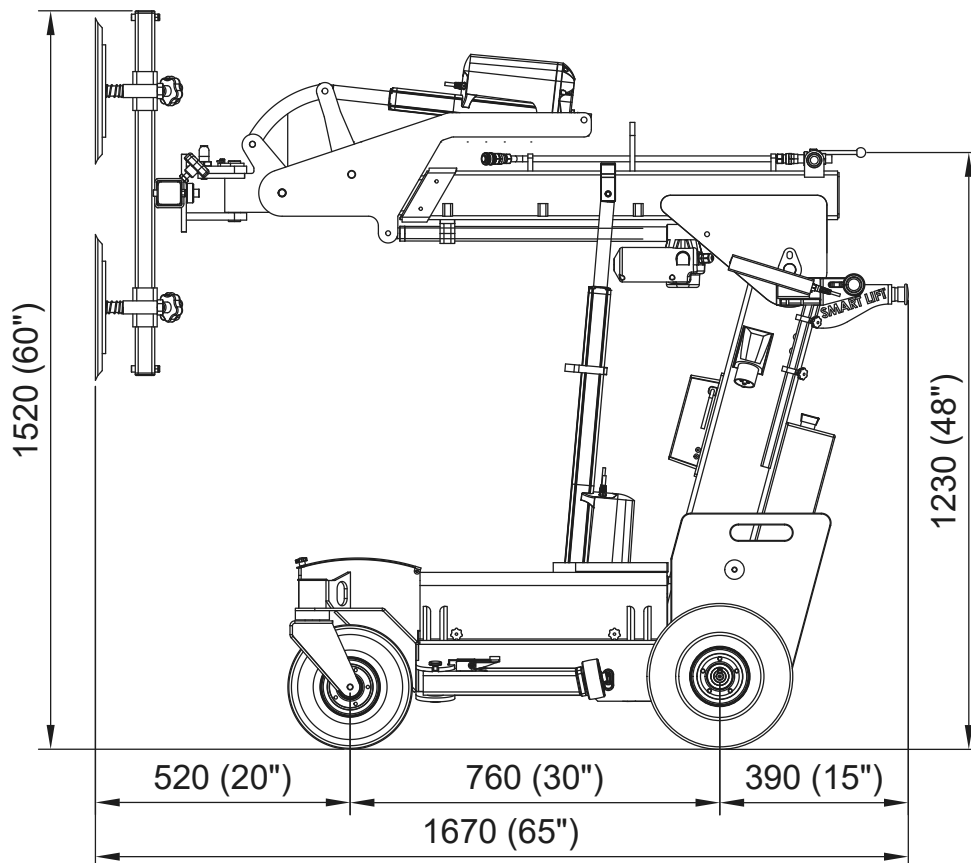
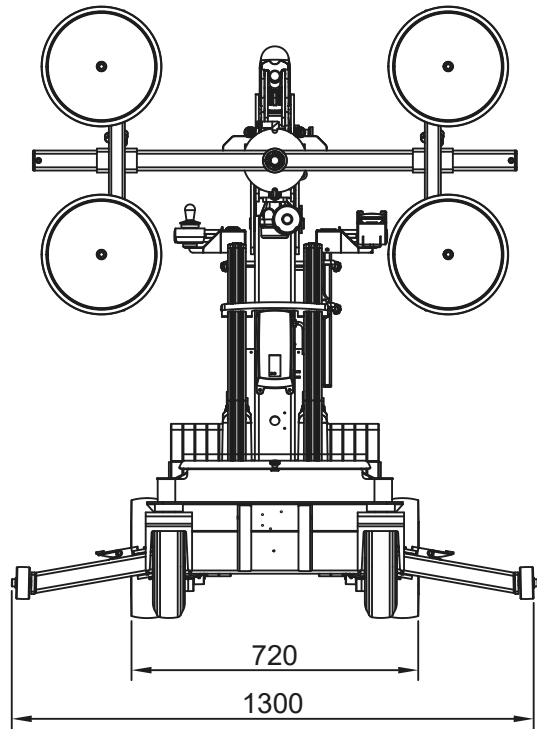

# SL208 INDOOR

